



**MINISTRY OF ECONOMY,
COMMERCE AND TOURISM**

152 Calea Victoriei street, District 1, Bucharest, ROMANIA

Phone: +4 021 4010504; Fax : +40 21 4010594

Email: dgre@dce.gov.ro

www.dce.gov.ro



ASFOR

**ASSOCIATION OF
THE ROMANIAN FORESTRY INDUSTRY**

46 F, Șoseaua Pipera Street, District 2,
020112 Bucharest, ROMANIA

Phone: 00 40 212 326 333; Fax: 00 40 21 232 10 72;

E-mail: asfor@rdsmail.ro

www.asociatiaforestierilor.ro



RUMÄNIEN

BEI



Koln - Germany

5 - 8 May 2015



HALL 05 - stand C 088



RUMÄNIEN

BEI



ASFOR

ROMANIAN FORESTRY ASSOCIATION

KoIn - Germany
5 - 8 May 2015

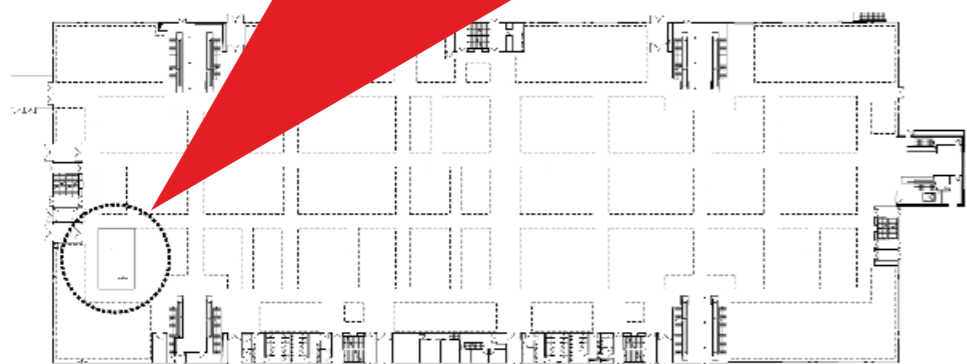
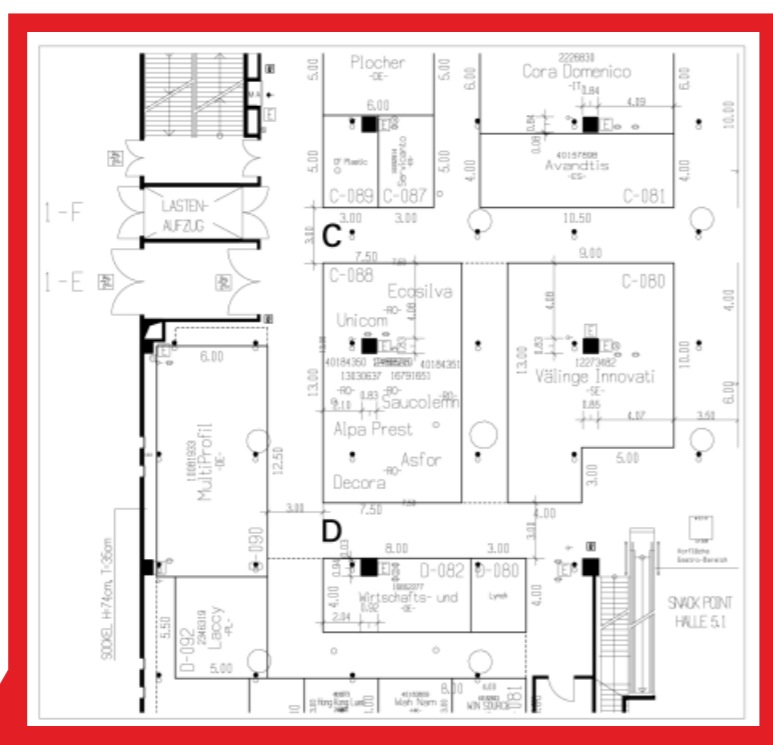

Romanian Forestry Association ASFOR (RFA) is founded in 1994 year. RFA is a employer and professional organisation of the companies from the forest exploitation and primary wood conversion area represents juridical, economical and technical interests of the forest exploitation and wood working industries wich compose it, in relation with the authorities and other employer associations.

Through its 800 member companies makes more than 85% of the industrial production from this activity branch.

The goals of the association are:

- to develop the relation ships between its member companies
- represent officially its member interests before the international and domestic authorities
- to influence: the branch laws, the national authority decisions as well as the elaboration of typical standards with the view of the national forest industry development
to achieve specific-nature services to its members advantage
- to promote the judicious utilization at a real value of the invaluable renewable ecological material named wood
- to ensure the informations and studies about the up-to-date technologies in the branches for the maximization of the economic efficiency and for the integral utilization of all production capacities
- to organize the participation of its members at the fairs, exibitions and symposiums
- to organize consultations and actions for the training and improvement of the workhand.

CONTACT:
46F Pipera Street,
Bucharest 2, 020112

Phone/Fax: 004021-2321072;
Phone: 004021-2326333; 2333705

asfor@rdsmail.ro
www.asociatiaforestierilor.ro



ALPA PREST



DeCORA folii si furnire



IMAGELINE



ECOSILVA



SAUCOLEMN



SIGSTRAT



UNICOM HOLDING

ALPA PREST

S.C. ALPA PREST S.R.L. was founded in 1996, registered in the Trade Register, registration number J40/1691/1996, fiscal registration: RO 8222010, Caen code 1623 with headquarters in Bucharest, Cpt.Av.Alexandru Serbanescu Street, Nr. 40; sector 1, with his main scope of activity consisting of the custom-made wooden doors and windows production.

ALPA PREST disposes of a strong production base consisting of: Two interior wooden door production factories with various veneer types, layered wooden doors and windows with double glazing glass, furniture, stairs, railings, ledges, plinths, paneling, fences, decking heat-treated acacia and ash etc., situated in the Afumati commune, 57 A Stefanesti Street, Ilfov country (Near Bucharest) and the Dridu commune, Ialomita country (timber Factory).



ALPA PREST's main values are professionalism and quality.

As it is based on its employees' experience in the wood field, on the carried out works' and the used materials' quality, ALPA PREST carries out works for natural entities as well as especially for legal entities throughout the country's regions and the company disposes of material storage units as well as an auto park equipped with everything necessary for the activity to be carried out under optimum conditions. Only wood from various specially selected essences is used in the fabrication process (treated in

our own drying plant) and natural veneers from various species: oak, cherry tree, mahogany, walnut, wenge, zebrano in various shades.

The product range made available to our clients has a technologically superior quality: it is esthetically remarkable, it has mechanical resistance, it is fire proof, anti-break in, it has good tightness, the best quality finishes.

We have managed to carry out models of doors, furniture, windows which have changed the homes' design, allowing each client to select their desired model type, for any requested size.

Our company set quality as its goal for the permanent satisfaction of our clients' requirements who can be that the purchased product corresponds to the highest quality norms.

To view our products you can visit the site www.usi-alpa.ro or if you have a different model we wait your details.

We are waiting for the technical details about your chosen models on the email: office@usi-alpa.ro.

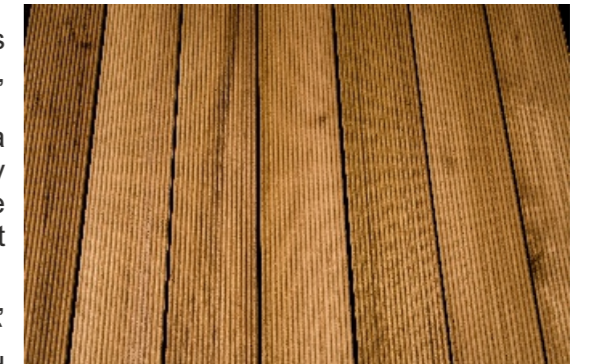

HEADQUARTERS: STR. CPT. AV. ALEX. SERBANESCU NR.40, SECTOR 1, BUCHAREST; C.I.F: RO8222010; J40 / 1691/1996, FACTORY AFUMATI, JUDETUL ILFOV: STR. STEFANESTI no.57 TEL / FAX: 021.351.31.18/021.351.31.19, EMAIL: office@usi-alpa.ro / SITE: www.usi-alpa.ro





DeCORA folii si furnire srl is producing veneer rolls, for edgebandings and for wrapping.

- all kind of veneer, natural or recomposed,
- with or without backfleecing,
- with or without sanding,
- with or without preglueing



You can contact us in English or German by:
Factory: 5, Pictor C Minisan Street, RO-310208, Arad, Romania
Phone: +40 745 604 683
Fax: +40 357 445 725
decoragroup@gmail.com



Ecosilva: Italian excellence, Romanian manual labor, world market. This is a brief definition which introduce you in to the world of Ecosilva.

Our company, specialized in producing accessory and complete furniture handcraft is offering to his customers, besides all wood's decorations from the catalogue, the opportunity to realize ,exclusively, projects and prototypes by customizing measurements.

All our creations are attended very carefully and

in a meticulous way starting from selecting wood to the manual carvings that our greats artists realizes, to the finishing. Therefore we like to call all our products "wood's jewelry".

Our production: mirror frames, console, headboards, chairs, architectural details – all handcarved.



ECOSILVA PROD COM SERV SRL
OFFICE:600211-BACAU,Neagoe Voda street no 31 B 3
PHONE:0040234546298
FACTORY:540390-TARGU MURES,BUDIULUI STREET NO 70
PHONE:0040265265615
e-mail:ecosilvaoffice@yahoo.it
www.ecosilvastyle.com



imageline®

Str. Bethlen Gábor nr. 55, 535600, Odorheiu Secuiesc - HR, Romania

E-mail: office@imageline.ro, Tel: +40-266-218083, Fax: +40-266-214173

www.imageline.ro, www.intarzia.ro, www.infowood.ro, www.expowood.ro

Imageline

Imageline srl is a company from Odorheiu Secuiesc, well capitalized and specialized in editing, advertising, marketing, and communication services.

Our beneficiaries are corporations who desire complete quality services, who require punctuality and exigency. Our services are mainly aimed at companies in the woodworkers' trade. For those in the field, we provide very advantageous collaborations and we emphasize loyalty building.

The company's main activities: editing the Intarzia&Castor woodworking magazine and organizing the Expowood Forestry and Woodworking Trade Fair. At the same time, we are organizing partners in a large number of other trade events. We believe that we have the experience and professionalism necessary to be able to take advertising campaign projects to completion, by creating and projecting catalogues, flyers, portfolios, banners etc., to organize marketing communications, as well as to create corporation identity.

Over its 17 years of publication, the Intarzia&Castor Magazine has achieved the performance of attaining and maintaining its status as leader of the specialized press in the wood industry from Romania.



The Intarzia magazine - leader in the professional press from the wood industry of Romania - monitors the information, news, innovations, events, and technological tendencies in the European Union.

Its collaboration with prestigious magazines in the technical area from Germany, Italy, Austria, and Hungary, make the magazine the most important information provider in our guild concerning news, markets, management, education, and events. Its consistent presence on the internal market and, in particular, on the European market, led to the achievement of a continuous channel of communication between readers and the European market.

The readers fall into two categories: subscribers and occasional readers. The subscribers receive the magazine by mail, wrapped in plastic, regularly, on a fixed date. Occasional readers receive the Intarzia magazine by mail, 2 or 3 issues per year, or via direct contact on the occasion of its distribution in fairs, symposiums, and conferences. According to calculations, the number of permanent readers amounts to approximately 12,000 persons.

SAUCOLEMN

Set up in 1994, SAUCOLEMN Company situated in north Romania established itself as a regional leader in the woodworking industry, running an activity which starts with cutting the timber, steaming, drying, the making of laminated panels from derivatives of panels - indoor stairs, laminated doors and windows.

The products are realised using high technology equipment and they have been displayed at international fairs in Hanover and Milan.

This fact together with our way of organising the technological flux, using only wood from controlled landscaped forrests, led to the achieving of the following certifications of product quality:

-DQS GmbH, for certifications BH OHSAS 18001:2007 and ISO 9001:2000

-IQ Net, for certification ISO 9001:2000

-FOREST STEWARDSHIP COUNCIL A.C., for certification FSC.

1. Edge glued beech panels - this is our main product and it is produced in two versions: finger jointed panels and solid wood panels. Both versions are made out of slightly steamed timber. The maximum sizes are 50 x 1250 x 6000 mm. We produce 4 quality classes of beech panels - class A/B - face A, it means without knots, without cracks, without a red heart or coloration (blue or black coloration), without any repair works and all the constituent laminations have a UNIFORM COLOUR in the PANEL.

CLASS B/B - face B, this means without knots, cracks, red heart, coloration (blue or black coloration), without any repair works, but there are differences in shades between the constituent elements of the panel, mostly as a steaming consequence.

- Class C/C technical - face C technical, this does not allow knots or cracks, but there are red hearts, healthy coloration of any kind, small repairing work using lute/putty but just on one side.

- class C/ C rustic - face C rustic healthy knots are unlimittedly accepted as well as falling knots and small repaired cracks, red hearts, and coloration of any kind.

2. LAMINATED BEAMS FOR DOORS AND WINDOWS - these are made of beech and oak wood in three layers.

3. INDOORS STAIRS - these are made of edge glued beech and oak panels using specialised software (designing Compass and CNC robot in 5 axes for execution) and thus we are flexible in accomplishing individualized projects, different from client to client.

4. Doors and windows made of laminated wood - Saucolemn has the advantage to be able to produce the doors and windows in arches and rear-arches or any other irregular shapes, while the making these products would not be possible using classical technology.

5. Tables made of laminated panels - these tables can be varnished or oiled, in different shapes - square, rectangular, round or oval.



**Address: Vama, 727590, Street Petru Rares, no.12A,
Suceava, Romania
Phone/fax: 0040 230239031
Mobile: 0040 744590277
Email: office@saucolemn.ro
www.saucolemn.ro**

RUMÄNIEN BEI INTERZUM - Köln, Germany





SIGSTRAT

SIGSTRAT SA, commercial company was founded in 1993 being separated from the departments of semifinished products and wooden boards of the former wood processing plant, Sighetu Marmatiei.

From the moment the company came into being and for the time being it diversified its activity. Now we make beech plywood, moulded beech elements, chairs, tables and other wooden products.

We are constantly concerned of modernizing and renewing the technology of our production departments with new equipments new technology and performance of our production to meet the quality requirements of the European standard.

MOULDED ELEMENTS FOR SEATS AND BACKS

Elements ready for being assembled on metal framework, seats and backs having a high grade of finishing and superior quality in more than 250 models, made in accordance with the requirements of our clients so that they fit exactly during the assembling work. We use high quality lacquer having special characteristics that they meet the requirements (antiscratches, waterproof, antigliding a.s.o.)

SEATS AND BACKS FOR UPHOLSTERY USE

Seats and backs for being upholstered are made with high precision on CNC machines specialized so that the assembling work becomes easy.

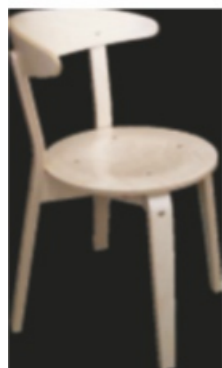

Address: 435500 Sighetu Marmatiei, Str. Unirii 40
Maramures – Romania
Phone: 0040-262 317.575,
Fax: 0040-262.315.464
E-mail: sigstrat@sigstrat.ro
Web site: www.sigstrat.ro



Unicom Holding SA , a Romanian private society , established in the year 1993, started in 2000 its activity in the domain of wood processing. The investment , still in a continuous development, concretizes in a modern factory for wood processing, situated in Rosiorii de Vede town, Teleorman district.

In order to produce Massive Panels we use both the finger jointing technology as well as edge gluing. We produce finger jointed panels with a maximum length of 6000 mm, a width of 1220 mm, and a thickness between 18-45 mm. The capacity of the new factory is abt. 200 cbm /month.

The modern technology used for the fabrication process as well as the qualified employees allow us to obtain quality products, that have passed the quality tests imposed by our foreign partners (Germany, Denmark, Sweden, France) and who give us assurance that our products face the competition imposed by joining the European Union.



Contact person : Mihaela Czipczer
General Deputy Manager
UNICOM HOLDING SA
1-IA Pipera Bvd, Voluntari, Ilfov , 0077190
Tel : + 40 21 2329918
Fax : + 40 21 2329928
Email : mihaela.czipczer@unicom-group.ro
www.unicom-group.ro

Production :
Unicom Wood Production
42 Oltului street , Rosiorii de Vede
Teleorman county
Romania

